

HEXAGON NUT HEIGHT = 3D  
 ZESKANTMOER 3D HOOG  
 ECROU HEXAGONAL HAUTEUR 3D  
 SECHSKANTMUTTER 3D HOCH

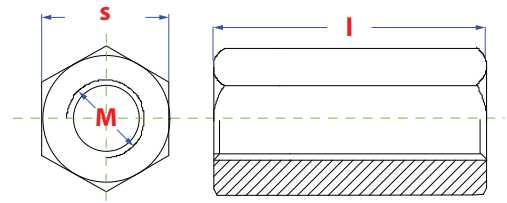

<b>material</b> : Steel class 5	<b>materiaal</b> : Staal klasse 5	<b>matière</b> : Acier classe 5	<b>Werkstoff</b> : Stahl Klasse 5
<b>type</b> : standard	<b>type</b> : standaard	<b>type</b> : standard	<b>Typ</b> : normalmass
<b>surface</b> : zinc plated Cr3+	<b>oppervlak</b> : verzinkt Cr3+	<b>surface</b> : zingué Cr3+	<b>Oberfläche</b> : verzinkt Cr3+

Technical properties | Technische gegevens | Données techniques | Technische Daten

M	OLD CODE	NEW CODE	EAN	BOX	s
3	06334,03 Z	006334001003000093	5410439140638	200	SW5,5
4	06334,04 Z	006334001004000123	5410439306997	200	SW7
5	06334,05 Z	006334001005000153	5410439072779	200	SW8
6	06334,06 Z	006334001006000183	5410439072809	100	SW10
7	06334,07 Z	006334001007000213	5410439127561	100	SW11
8	06334,08 Z	006334001008000243	5410439072830	100	SW13
10	06334,10 Z	006334001010000303	5410439072861	100	SW17
12	06334,12 Z	006334001012000363	5410439072892	50	SW19
14	06334,14 Z	006334001014000423	5410439104791	50	SW22
16	06334,16 Z	006334001016000483	5410439072939	25	SW24
18	06334,18 Z	006334001018000543	5410439104784	25	SW27
20	06334,20 Z	006334001020000603	5410439072977	10	SW30
22	06334,22 Z	006334001022000663	5410439213837	15	SW32
24	06334,24 Z	006334001024000723	5410439073011	10	SW36
27	06334,27 Z	006334001027000813	5410439176743	10	SW41
30	06334,30 Z	006334001030000903	5410439176750	5	SW46

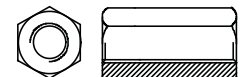

<b>material</b> : Stainless steel A2	<b>materiaal</b> : Roestvast staal A2	<b>matière</b> : Inox A2	<b>Werkstoff</b> : Edelstahl A2
<b>type</b> : standard	<b>type</b> : standaard	<b>type</b> : standard	<b>Typ</b> : normalmass
<b>surface</b> : plain	<b>oppervlak</b> : blank	<b>surface</b> : brut	<b>Oberfläche</b> : roh

Technical properties | Technische gegevens | Données techniques | Technische Daten

M	OLD CODE	NEW CODE	EAN	BOX	s
6	06334,06 A2	006334A00006000183	5410439072786	100	SW10
8	06334,08 A2	006334A00008000243	5410439072816	100	SW13
10	06334,10 A2	006334A00010000303	5410439072847	50	SW17
12	06334,12 A2	006334A00012000363	5410439072878	50	SW19
16	06334,16 A2	006334A00016000483	5410439072915	25	SW24